

Bali 4.8 (2020) - Vaya Con Dios

TECHNICAL SPECIFICATIONS AND DECK LAYOUT:

Year	2020
Location	Kaštela
Cabins	6
Bathrooms	6
Berths	12
LOA	14,86 [m]
Waterline length	14,28 [m]
Beam	7,88[m]
Draft	1,35[m]
Displacement	15,30 [t]
Engine	Diesel, 2 x 57 [hp]
Fuel tank	cca. 1000 [l]
Fresh water tank	cca. 1000 [l]
Total sail area	128 m ²
CE Certificate	A - 14 passengers
Design	Hervé COUEDEL

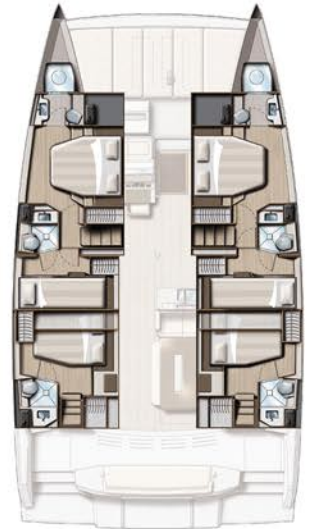

STANDARD EQUIPMENT AS PER STANDARD SPECIFICATION, ADDITIONAL EQUIPMENT:

Combined battery charger 80 amp - Inverter 12V (or 24V)/220V - 2000VA2 12V extra service batteries of 130 amp, Battery controller
 Indirect lighting in saloon/cockpit and cabins
 Forward cockpit and transom courtesy lighting
 Mainsail electrical winchlifting system for dinghy
 Electric windlass 1700W
 Extra fuel and water tank of 400L for a total capacity of 1000L
 Saloon tilting bay/door mechanically assisted by hydraulic struts
 Opening window between salon and foredeck cockpit
 Helmstation & Aft benchseat, flybridge benches and forward cockpit cushions
 2 layers of antifouling with Epoxy base coat
 Raymarine Electronic PACK including : Pilote auto P70S, GPS plotter AXIOM 7", MULTI I70S,VHF RAY 63 +VHF RAY MIC at steering station,AIS receiver transmitter, 12 " full touch screen at steering station
 Reinforced Dacron full batten Mainsail & Solent with UV protection
 Lazy-Bag & Lazy-Jack
 2 x Yanmar 57 hp instead of Yanmar 45hp
 Interior upholstery - Color Marlin PARCHMENT
 Other external upholsteries Marlin PARCHMENT (extra for non-standard color Vinyl)
 Stern spring cleats

ADDITIONAL COMPONENTS:

Large fixed Bimini with LED lighting
 Forward cockpit fixed table
 Sunbathing cushions for foredeck and flybridge
 Big comfortable pillows (4 pcs)
 Permanent transom protection
 LCD TV in saloon + Glomex antenne
 Music stereo system with USB, Bluetooth and 6 speakers
 Anchor chain counter
 Generator 15 KW
 Air condition for all cabins and slaon 52.000 BTU
 Kit Solar panels 4 x 100 W
 12V fan per cabin (6 pcs)
 ABSICO electrical toilets, sea water flush(6 pcs)
 Coffee machine, Microwave
 LED underwater lights at each transom (4 pcs)
 Blackout curtains at each cabin & corridors
 Teak on aft transom steps and aft cockpit floor
 Charter equipment & Charter make-ready pack

regular price 803.930 EUR
736.433 EUR*
 FULLY EQUIPPED FOR CHARTER

VALID TILL 30.05.2020.

* The prices do not include VAT

* The above indicated prices are valid only if the charter management contract is signed (minimum two years period)

Become a part of the Bali Yachting World charter management program, and take advantage of the key benefits!

OUR KEY BENEFITS

- Minimal investment or participation in boat acquisition
- Special purchase conditions for your boat
- Favorable financing conditions through affiliate leasing companies
- High charter income based on minimum of 20 weeks per season (fleet average of 21,5 weeks/boat)
- Transparent cash flow reports through constant insight in income and expenses
- Financial security with insurance against loss of charter income
- High quality aftersales support with prompt processing of claims throughout warranty
- High maintenance standards ensure the best resale value for your boat regardless of age

SIMPLIFIED PROFIT CALCULATION:

Annual charter income* (Yacht owner)	107.901 €
Annual expenses* (marina, insurance, registration, maintenance...)	29.787 €
Net profit* (Yacht owner)	78.114 €

* The figures do not include VAT

* Charter cash flow is based on 20 booked weeks per season